

Entering The California Science Center



People get to the science center in different ways. Some people drive in a car, take a bus, or ride the train. **How will I get there?**



When I get to the front of the museum, I will probably walk through the outdoor **rotunda**. A rotunda is a round room with a round ceiling. If I look up inside the rotunda, I will see very interesting things.



The rotunda **may be quiet**, or it **may be loud**. If it is crowded, I will do my best to stay close to the people I came with.

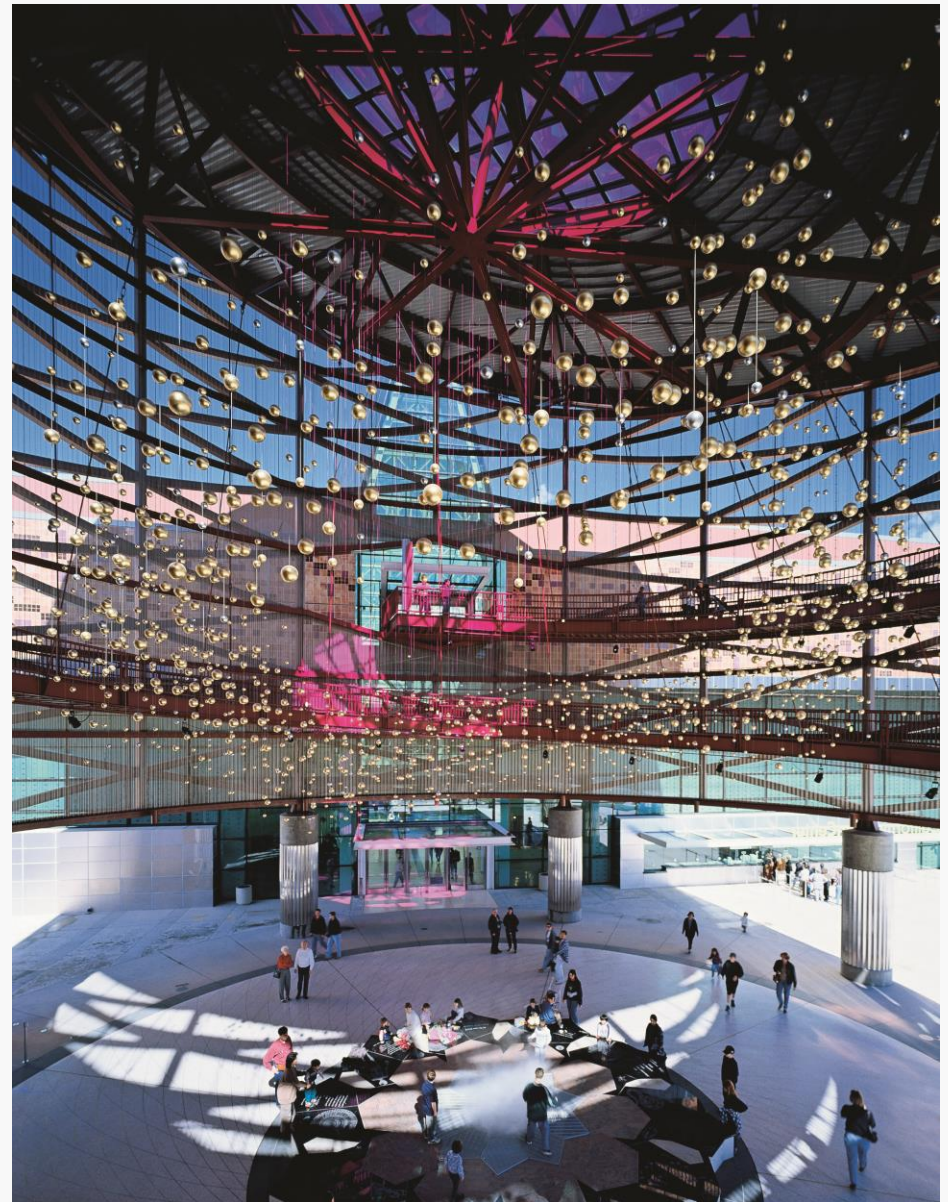

When I am ready **to go inside**, I can walk through the sliding-glass doors into the museum.



Inside, I will see the Information Desk and the ExploraStore gift shop. If I keep walking straight, I will see the food court.



When I am ready to see the exhibits, I can use the **stairs, escalator, or elevator** to go to the second floor.

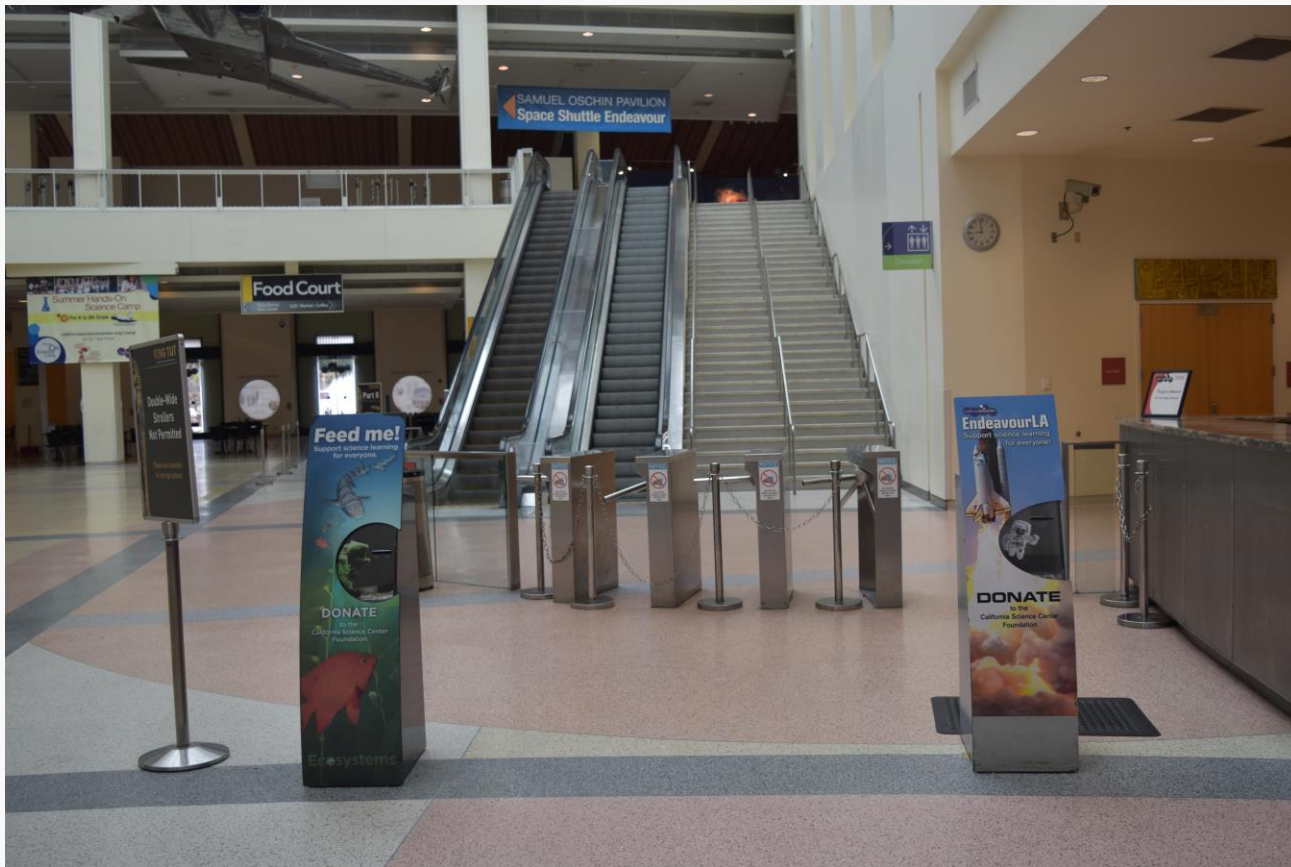

If I need help at any time while I am at the museum, I can talk to a **museum staff member**. They will be wearing a California Science Center shirt or jacket.

